

# FINEDARER

PNEUMATIC INDUSTRIAL TOOLS

## PRECISION RIVETING & GRINDING SOLUTIONS

BUILT FOR PERFORMANCE.  
DESIGNED FOR RELIABILITY.

### PROFESSIONAL TOOLS FOR AEROSPACE & INDUSTRY

Engineered for demanding applications.  
Trusted by professionals worldwide.



TAIWAN  
MANUFACTURING  
EXCELLENCE



OEM / ODM  
SERVICE



QUALITY  
ASSURANCE



GLOBAL  
EXPORT



MADE IN TAIWAN  
TRUSTED BY PROFESSIONALS WORLDWIDE

[www.finedarer.com](http://www.finedarer.com)

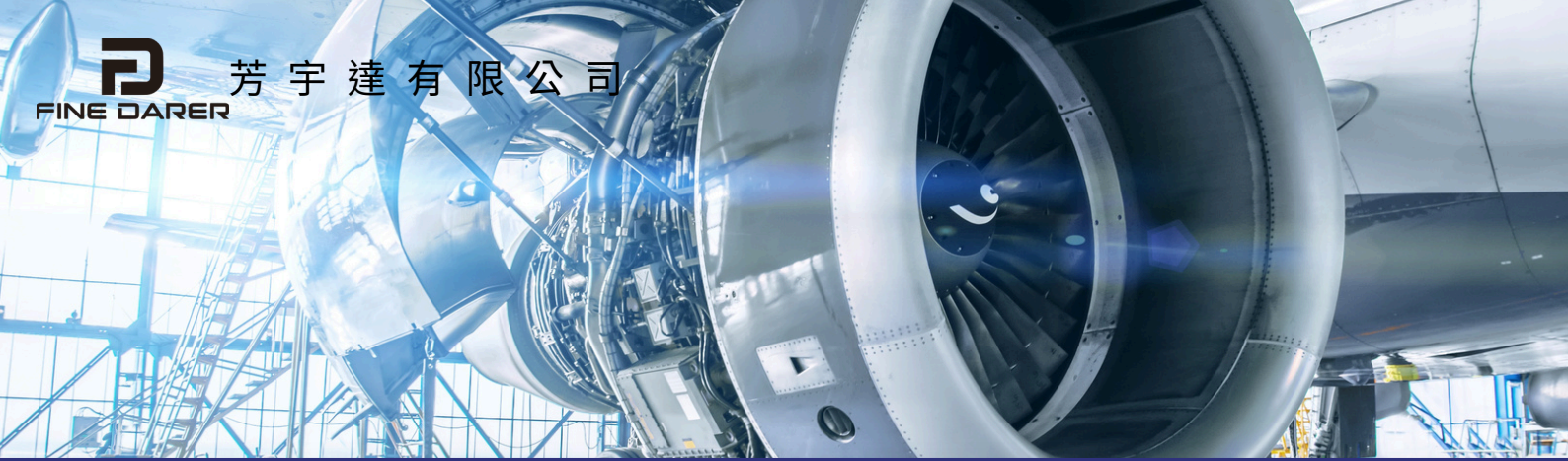

# TABLE OF CONTENTS

2026



RIVET HAMMERS  
BUCKING BARS  
RH BOX

1-4



VIBRATION DAMPED  
RIVETING HAMMERE

VIBRATION DAMPED  
BUCKING BARE

5



CHIPPER HAMMERSE

6-7



FLUX CHIPPER / NEEDLE SCALERS  
LOW VIBRATIONE  
FLUX CHIPPERS / NEEDLE SCALERS

8

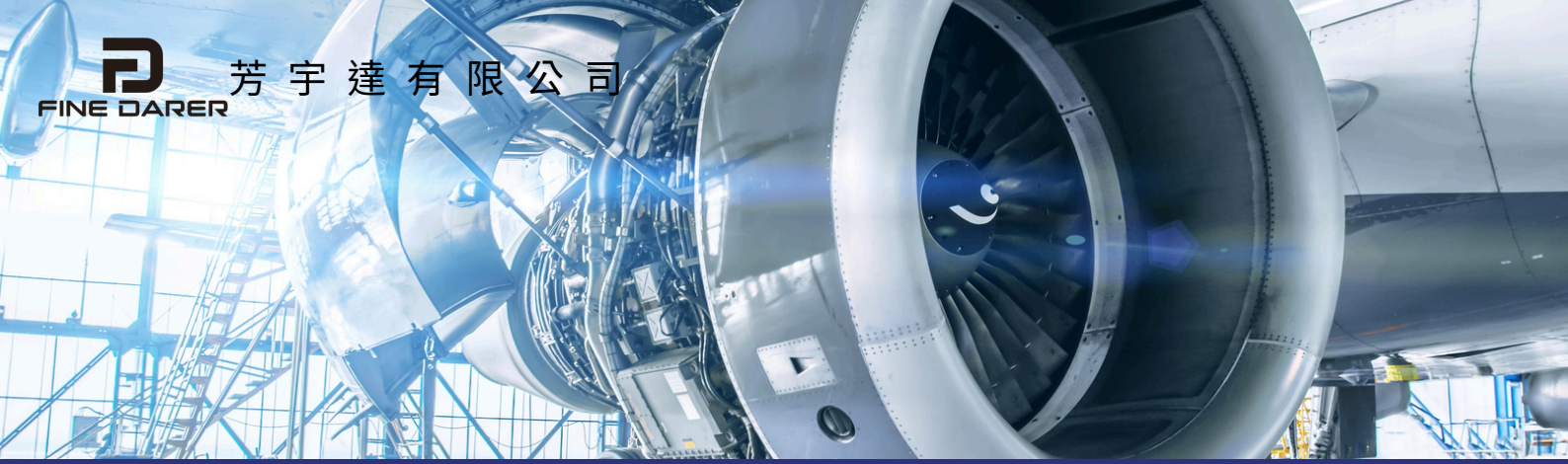

# TABLE OF CONTENTS

2026



SAND RAMMERE

9



ONE SHOT HAMMER

10



DIE GRINDERS

ANGLE GRINDERS (2")

ANGLE GRINDERS (4",5",7")

VERTICAL GRINDERS

STRAIGHT GRINDERSE

10-12



[L] TYPE OFFSET DRILL ATTACHMENT

13

# RIVET HAMMERS



**Push-button** Throttle Type



RH-9501XS(0.86kg)  
RH-9502XS(1.06kg)  
RH-9503XS(1.16kg)  
RH-9504XS (1.27kg)

**Level** Throttle Type



RH-9501 XSL (0.86 kg)  
RH-9502 XSL (1.06 kg)  
RH-9503 XSL (1.16 kg)  
RH-9504 XSL (1.27 kg)

**XG Extended Body** Handle Type



RH-9502 XG (2.06 kg)  
RH-9503 XG (2.16 kg)  
RH-9504 XG (2.19 kg)

Longer overall length for deeper reach

**Standard** Handle Type



RH-9501X (1.06 kg)  
RH-9502X (1.26 kg) / RH-9502P (1.26 kg)  
RH-9503X (1.36 kg) / RH-9503P (1.36 kg)  
RH-9504X (1.39 kg) / RH-9504P (1.39 kg)

**Adjustable air flow** Handle Type



RH-9501 XA (1.06 kg)  
RH-9502 XA (1.26 kg) / RH-9502 PA (1.26 kg)  
RH-9503 XA (1.36 kg) / RH-9503 PA (1.36 kg)  
RH-9504 XA (1.39 kg) / RH-9504 PA (1.39 kg)

## TECHNICAL SPECIFICATIONS All models: Air inlet 1/4 PT /Air hose 9.5 ID

Model	Chisel Shank (inch)	Bore Diameter		Piston Stroke		Blow Per Min (B.P.M)	Overall Length		Air Inlet (PT)	Air Hose (ID)	Rivet Nuts		Max. Air consumption	
		MM	INCH	MM	INCH		MM	INCH			Steel	Alum	CFM	L/min
RH-9501X	0.401	14.3	9/16	35	1-3/8	2850	115	4.49	1/4	9.5	3/32	1/8	4	114
RH-9501XS	0.401	14.3	9/16	35	1-3/8	2850	160	6.3	1/4	9.5	3/32	1/8	4	114
RH-9502X	0.401	12.7	1/2	59.8	2-1/4	2580	170	6.63	1/4	9.5	3/32	1/8	4	114
RH-9502XS	0.401	12.7	1/2	59.8	2-1/4	2580	215	8.39	1/4	9.5	3/32	1/8	4	114
RH-9502XSL	0.401	12.7	1/2	59.8	2-1/4	2580	197.5	7.77	1/4	9.5	3/32	1/8	4	114
RH-9502XG	0.401	12.7	1/2	59.8	2-1/4	2580	260	10.23	1/4	9.5	3/32	1/8	4	114
RH-9502P	0.401	14.3	9/16	59.8	2-1/4	2580	170	6.63	1/4	9.5	3/32	1/8	4	114
RH-9503X	0.401	12.7	1/2	76.3	2-7/8	2160	186	7.25	1/4	9.5	5/32	3/16	4	114
RH-9503XS	0.401	12.7	1/2	76.3	2-7/8	2160	231	9	1/4	9.5	5/32	3/16	4	114
RH-9503XSL	0.401	12.7	1/2	76.3	2-7/8	2160	220	8.66	1/4	9.5	5/32	3/16	4	114
RH-9503XG	0.401	12.7	1/2	76.3	2-7/8	2160	280	11.02	1/4	9.5	5/32	3/16	4	114
RH-9503P	0.401	14.3	9/16	76.3	2-7/8	2160	186	7.25	1/4	9.5	5/32	3/16	4	114
RH-9504X	0.401	12.7	1/2	96.8	3-1/16	1740	211	8.22	1/4	9.5	3/16	1/4	4	114
RH-9504XS	0.401	12.7	1/2	96.8	3-1/16	1740	256	9.98	1/4	9.5	3/16	1/4	4	114
RH-9504XSL	0.401	12.7	1/2	96.8	3-1/16	1740	240	9.44	1/4	9.5	3/16	1/4	4	114
RH-9504XG	0.401	12.7	1/2	96.8	3-1/16	1740	300	11.81	1/4	9.5	3/16	1/4	4	114
RH-9504P	0.401	14.3	9/16	96.8	3-1/16	1740	211	8.22	1/4	9.5	3/16	1/4	4	114

# RIVET HAMMERS

## Hammer Chisel FOR:RH-9501X

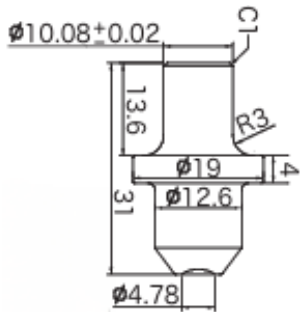

YM719

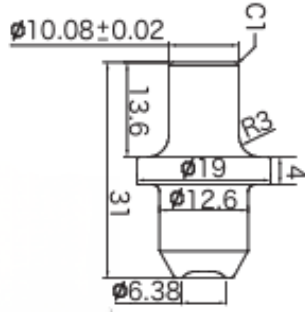

YM720

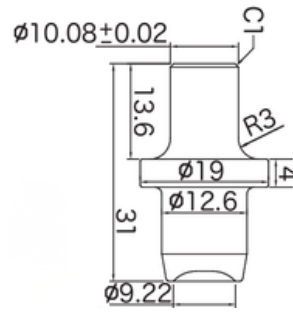

YM721

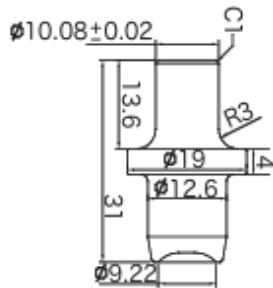

YM722

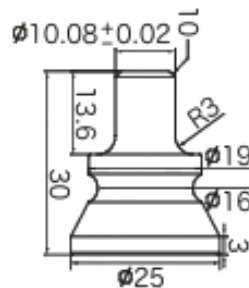

YM723



R-851006

## Hammer Chisel FOR:RH-9502X~RH-9504X

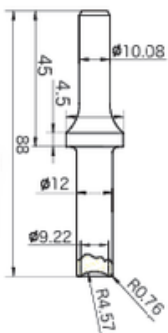

YM901

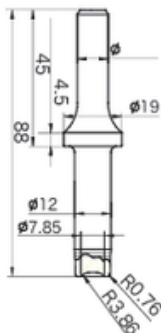

YM902

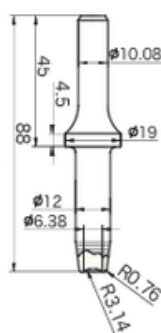

YM903

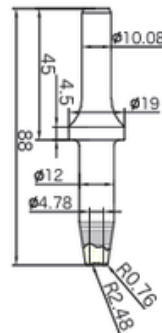

YM904

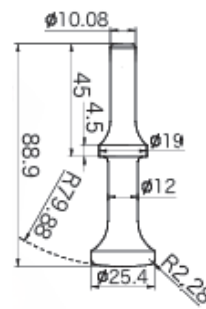

YM905



R-852020



R-852019

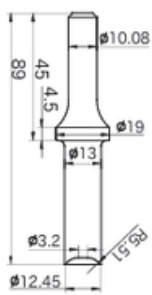

YM906

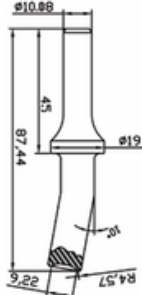

YM907

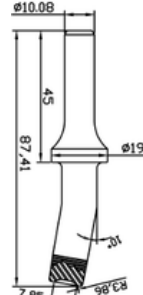

YM908

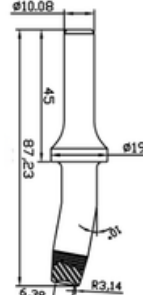

YM909

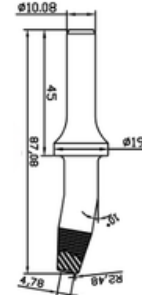

YM910



QC-9504

# RIVET HAMMERS



RH-9505X(2.1kg)  
RH-9507X(2.4kg)  
RH-9509X(2.5kg)



RH-9505XG (3.3kg)  
RH-9507XG (3.6kg)  
RH-9509XG (3.7kg)

Model	Chisel Shank (inch)	Bore Diameter		Piston Stroke		Blow Per Min (B.P.M)	Overall Length		Air Inlet (PT)	Air Hose (ID)	Rivet Nuts		Max. Air consumption	
		MM	INCH	MM	INCH		MM	INCH			Steel	Alum	CFM	L/min
RH-9505X	0.498	19	3/4	68.3	2-11/16	1600	230	8.97	1/4	9.5	3/16	1/4	6	170
RH-9505XG	0.498	19	3/4	68.3	2-11/16	1600	315	12.4	1/4	9.5	3/16	1/4	6	170
RH-9507X	0.498	19	3/4	98.4	3-7/8	1140	256	9.98	1/4	9.5	1/4	5/16	6	170
RH-9507XG	0.498	19	3/4	98.4	3-7/8	1140	340	13.38	1/4	9.5	1/4	5/16	6	170
RH-9509X	0.498	19	3/4	147.6	5-13/16	900	284	11.07	1/4	9.5	5/16	3/8	6	170
RH-9509XG	0.498	19	3/4	147.6	5-13/16	900	390	15.35	1/4	9.5	5/16	3/8	6	170

## Hammer Chisel FOR:RH-9505X~RH-9509X

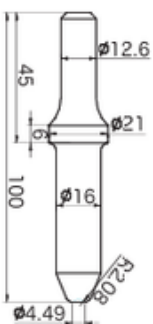

YM701

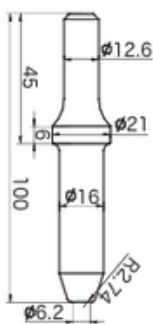

YM702

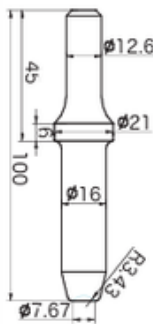

YM703

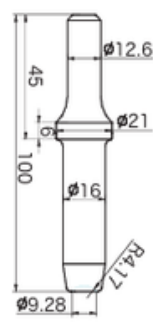

YM704

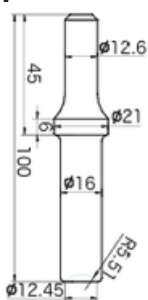

YM705

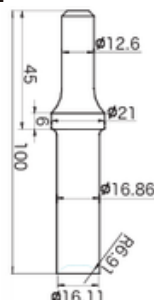

YM706

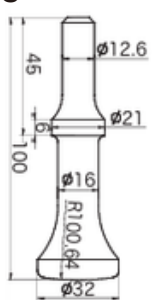

YM707



R-853012



R-853011



QC-9509

# BUCKING BARS

We adopt superior 4140 material to produce Bucking Bars, and the Bucking Bars are finished by casting method, the hardness of heat treatment: HRC46°~50°. Electro deposited coating. All sharp edges are deburred and working surfaces are polished for trouble-free use.

## BUCKING BARS



BB-670T

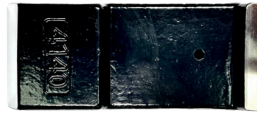

BB-638



BB-647



BB-1112

# RH BOX KITS

## RH BOX KIT



### RH BOX

THE RH BOX contains:

- 1PC RIVET GUN(CHOOSE SIZE 2X,3X OR 4X)
- 1PC BB-670T-BUCKING BAR
- 1PC BB-638-BUCKING BAR
- 1PC BB-647-BUCKING BAR
- 1PC BB-1112-BUCKING BAR
- 6PCS 3.5" RIVET SET  
(3/32",1/8",5/32",3/16",1/4",1")
- 1PC QC-9504

# VIBRATION DAMPED RIVETING HAMMER



VRH-04(1.2kg)

VRH-06(1.48kg)

VRH-08(1.58kg)

Model	Chisel Shank (inch)	Bore Diameter MM	Piston Stroke MM	Blow Per Min (B.P.M)	Overall Length MM	Air Inlet (PT)	Air Hose (ID)	Rivet Nuts Steel	Air Consumption CFM	Energy Per Blow J	Vibration Value m/s	Sound power dB
VRH-04	0.401	15	40	3960	200	1/4	9.5	2/32-5/32	6	2	<2.5	104
VRH-06	0.401	15	102	2160	260	1/4	9.5	1/8-1/4	19	6	3.9	103
VRH-08	0.401	15	137	1440	290	1/4	9.5	5/32-1/4	21	8	4.8	103

# VIBRATION DAMPED BUCKING BAR

The VBB Bucking Bar is the perfect partner for the VRH riveting hammer.

With its efficient vibration damping system the tool works well with the riveting hammer providing a high efficiency riveting team.



**Model** VBB-10

Weight 1.1 kg

Diameter 48mm



**Model** VBB-16

Weight 1.7 kg

Diameter 48mm

# CHIPPER HAMMERS



CH-4000 (2.62kg)



CH-4001 (6.87kg)



CH-4003 (7.54kg)



CH-4000A (2.63kg)



CH-4002 (7.2kg)



CH-4004 (8.3kg)

Model	Chisel Shank				Piston Diameter	Piston Stroke Length		Blow Per Min (B.P.M)	Overall Length		Air Inlet	Air Hose	Max. Air Consumption
	Round mm	Round in	Hex mm	Hex in		mm	in		mm	in			
CH-4000	14	0.55	12	0.47	20	45	1-3/4	3000	300	11-13/16	1/4"	3/8"	14 CFM
CH-4000A	14	0.55	12	0.47	20	45	1-3/4	3000	300	11-13/16	1/4"	3/8"	14 CFM
CH-4001	17.3	0.68	14.7	0.58	28.5	25.4	1	2100	375	14-9/16	3/8"	1/2"	21 CFM
CH-4002	17.3	0.68	14.7	0.58	28.5	50	2	1900	400	15-3/4	3/8"	1/2"	21 CFM
CH-4003	17.3	0.68	14.7	0.58	28.5	76	3	1700	420	16-17/32	3/8"	1/2"	24 CFM
CH-4004	17.3	0.68	14.7	0.58	28.5	102	4	1400	470	18-1/2	3/8"	1/2"	28 CFM



MCH-4001(7.69kg)



MCH-4002 (8.04kg)



MCH-4003 (8.5kg)



MCH-4004 (8.88kg)

Model	Chisel Shank				Piston Diameter	Piston Stroke Length		Blow Per Min (B.P.M)	Overall Length		Air Inlet	Air Hose	Max. Air Consumption
	Round mm	Round in	Hex mm	Hex in		mm	in		mm	in			
MCH-4001	17.3	0.68	14.7	0.58	28.5	60	2.16	2500	345	13-1/2	3/8"	1/2"	32 cfm
MCH-4002	17.3	0.68	14.7	0.58	28.5	77	3.03	2300	365	14	3/8"	1/2"	34 cfm
MCH-4003	17.3	0.68	14.7	0.58	28.5	94	3.7	2100	400	15-1/4	3/8"	1/2"	33 cfm
MCH-4004	17.3	0.68	14.7	0.58	28.5	102	4.02	1750	425	16-1/2	3/8"	1/2"	30 cfm

# CHIPPER HAMMERS



## FOR:CH-4000,CH-4000A

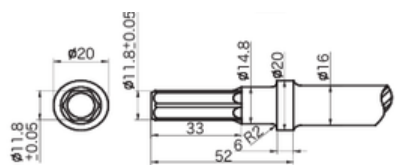

Φ16mm六角型 / Hex.11.8mm

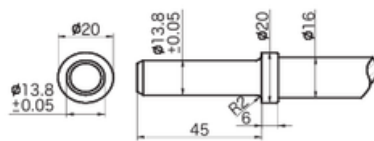

Φ16mm圓型 / Round 13.8mm

Moil Point  
YM101

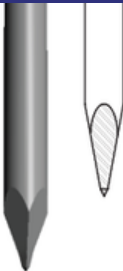

16mm Wide Cutting Chisel  
YM102

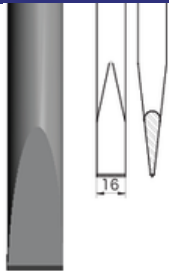

20mm Wide Cutting Chisel  
YM103

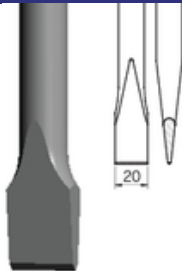

30mm Wide Cutting Chisel  
YM104

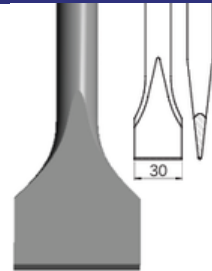

40mm Wide Cutting Chisel  
YM105

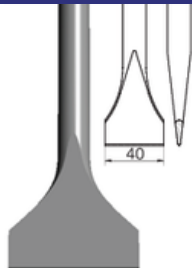

50mm Wide Cutting Chisel  
YM106

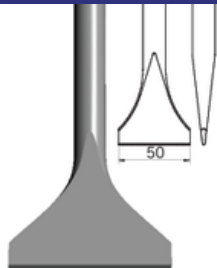

25mm Wide Cutting Chisel  
YM107

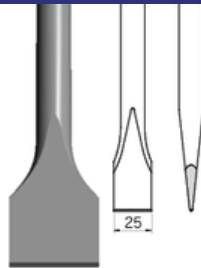

100mm Moon-shape Chisel  
YM108



## FOR:CH-4001~CH4004 & MCH-4001~MCH-4004

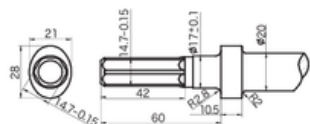

Φ20mm六角型 / Hex. 14.7mm (橢圓唇)

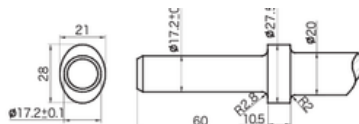

Φ20mm圓型 / Round. 17.2mm (橢圓唇)



QC-4004

Moil Point  
YM201

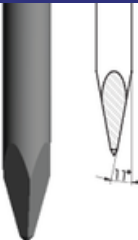

20mm Wide Cutting Chisel  
YM202

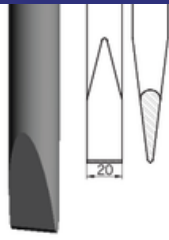

30mm Wide Cutting Chisel  
YM203

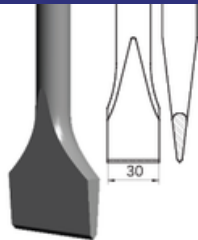

50mm Wide Cutting Chisel  
YM204

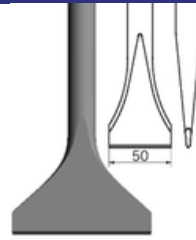

25mm Wide Cutting Chisel  
YM205

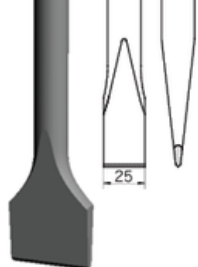

40mm Wide Cutting Chisel  
YM206

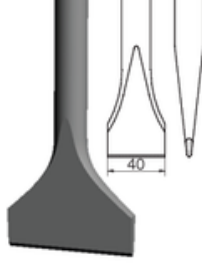

100mm Moon-shape Chisel  
YM208

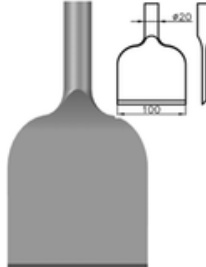

# FLUX CHIPPERS /NEEDLE SCALERS



Model	Speed B.P.M	Piston Diameter		Stroke		Overall Length		Weight kg	Air Hose Size		Air Inlet PT or NPT	Air Consumption	
		mm	in	mm	in	mm	in		mm	in		CFM	m <sup>3</sup> /min
FC-250	4,000	25	63/64	34	1-11/32	190	7-1/2	1.5	9.5	3/8	1/4	14	0.4
NS-250	4,000	25	63/64	34	1-11/32	413	16-1/4	2.6	9.5	3/8	1/4	14	0.4
FC-250L	4,000	25	63/64	34	1-11/32	730	28-3/4	1.5	12.7	1/2	1/2	14	0.4

# LOW VIBRATION FLUX CHIPPERS /NEEDLE SCALERS



Model	Speed B.P.M	Piston Diameter		Strok		Overall Length		Weight (kg)	Air Hose Size		Air Inlet PT or NPT	Air consumption	
		mm	in	mm	in	mm	in		mm	in		CFM	m <sup>3</sup> /min
VNS-223	2400	23.5	59/64	11	7/16	370	14-9/16	2.35	9.5	3/8	1/4	4	0.11
VFC-223	2400	23.5	59/64	11	7/16	435	17-1/8	2.95	9.5	3/8	1/4	4	0.11



Model	Speed B.P.M	Piston Diameter		Strok		Overall Length		Weight (kg)	Air Hose Size		Air Inlet PT or NPT	Air consumption	
		mm	in	mm	in	mm	in		mm	in		CFM	m <sup>3</sup> /min
VNS-203	2400	23.5	59/64	11	0.43	340	13-3/8	2.7	9.5	3/8	1/4	4	0.11
VFC-203	2400	23.5	59/64	11	0.43	395	15-9/16	3.2	9.5	3/8	1/4	4	0.11

# SAND RAMMER



SR-301



SR-302



SR-303



SR-302L



SR-303L



SR-304L

Model	Speed	Piston Diameter	Stroke	Overall Length		Weight	Air Inlet		Air Hose Size		Air Consumption	
	B.P.M			mm	mm		mm	in	kg	PT	mm	in
SR-301	1,500	18	50	280~360	11~14-1/4	1.6	1/4	9.5	3/8	14	0.4	
SR-302	1,000	22	65	380~470	14-1/2~18-1/2	2.95	3/8	9.5	3/8	17	0.5	
SR-302L	1,000	22	65	870~980	34-1/4~38-1/2	3.75	3/8	9.5	3/8	17	0.5	
SR-303	800	25.4	100	500~660	19-11/16~26	6	3/8	9.5	3/8	24	0.7	
SR-303L	800	25.4	100	1060~1210	41-47/64~47-5/8	8	1/2	12.7	1/2	24	0.7	
SR-304L	700	32	125	1080~1250	42-1/2~49-1/4	9.79	1/2	12.7	1/2	30	0.85	

# ONE SHOT HAMMER

One shot hammer for delicate operations requiring lower power, including the insertion of pins, bushings, collar caps, oil seals, etc. Each lever pull delivers a single blow of precise power.



MODEL	ORH-20
Power	2.25 N-m
Length	213 mm
Weight	0.9 kg
Air inlet	1/4"
Avg. Air Consumption	220cm <sup>3</sup> /stroke



MODEL	ORH-80
Power	3.13 N-m
Length	254 mm
Weight	1.2 kg
Air inlet	1/4"
Avg. Air Consumption	650 cm <sup>3</sup> /stroke

# DIE GRINDERS



FY-26A



FY-26B

Model	Throttle Type	Collet Size		Capacity				Free Speed	Air Hose Size		Overall Length		Weight (kg)	HP	Max. Air Consumption	
		mm	in	Grinding Wheel	Burr Head	mm	in		mm	in	mm	in			CFM	m <sup>3</sup> /min
FY-26A	Roll	6	1/4	25	1	13	1/2	24,000	8	5/16	170	6-11/16	0.66	0.4	14	0.4
FY-26B	Lever	6	1/4	25	1	13	1/2	24,000	8	5/16	179	7-3/64	0.77	0.4	14	0.4

# ANGLE GRINDERS



AG-102A



AG-102B

Model	Throttle Type	Grinding Wheel		Free Speed	Spindle Thread Size	Angle Head Height		Overall Length		Weight (kg)	HP	Max. Air Consumption	
		mm	in			mm	in	mm	in			CFM	m <sup>3</sup> /min
AG-102A	Roll	50	2	15,000	1/4-28 UNF	46	3	157	6-3/16	0.66	0.35	14	0.4
AG-102B	Lever	50	2	15,000	1/4-28 UNF	46	3	188	7-13/32	0.74	0.35	14	0.4

# ANGLE GRINDERS



AG-104AF (3/8 x 24UNF)  
AG-104AM (M8 x 1.25P)  
AG-105AC (5/8 x 11UNC)  
AG-105AF (3/8 x 24UNF)  
AG-105AM (M8 x 1.25P)  
AG-105AP (M14 x 2.0P)



AG-104BF (3/8 x 24UNF)  
AG-104BM (M8 x 1.25P)  
AG-105BC (5/8 x 11UNC)  
AG-105BF (3/8 x 24UNF)  
AG-105BM (M8 x 1.25P)  
AG-105BP (M14 x 2.0P)



AG-107AC (5/8 x 11UNC)  
AG-107AN (M10 x 1.5P)  
AG-107AP (M14 x 2.0P)



AG-109AC (5/8 x 11UNC)  
AG-109AN (M10 x 1.5P)  
AG-109AP (M14 x 2.0P)



AG-105ACB (5/8 x 11UNC)  
(Steel Brush)



AG-105BCB (5/8 x 11UNC)  
(Steel Brush)



AG-107BC (5/8 x 11UNC)  
AG-107BN (M10 x 1.5P)  
AG-107BP (M14 x 2.0P)



AG-109BC (5/8 x 11UNC)  
AG-109AN (M10 x 1.5P)  
AG-109AP (M14 x 2.0P)

Model	Throttle Type	Grinding Wheel		Free Speed	Spindle Thread Size	Angle Head Height		Overall Length		Weight (kg)	HP	Max. Air Consumption	
		mm	in			mm	in	mm	in			CFM	m <sup>2</sup> /min
AG-104AF	Roll	100	4	13,600	3/8 x 24 UNF	76	3	208	8-3/16	2	0.9	33	0.95
AG-104AM	Roll	100	4	13,600	M8 x 1.25P	76	3	208	8-3/16	2	0.9	33	0.95
AG-104BF	Lever	100	4	13,600	3/8 x 24 UNF	76	3	246	9-11/16	1.7	0.9	33	0.95
AG-104BM	Lever	100	4	13,600	M8 x 1.25P	76	3	246	9-11/16	1.7	0.9	33	0.95
AG-105AF	Roll	125	5	10,900	3/8 x 24 UNF	76	3	208	8-3/16	1.8	0.9	33	0.95
AG-105AM	Roll	125	5	10,900	M8 x 1.25P	76	3	208	8-3/16	1.8	0.9	33	0.95
AG-105AC	Roll	125	5	10,900	5/8 x 11 UNC	76	3	208	8-3/16	1.8	0.9	33	0.95
AG-105AP	Roll	125	5	10,900	M14 x 2.0P	76	3	208	8-3/16	1.8	0.9	33	0.95
AG-105BF	Lever	125	5	10,900	3/8 x 24 UNF	76	3	246	9-11/16	1.6	0.9	33	0.95
AG-105BM	Lever	125	5	10,900	M8 x 1.25P	76	3	246	9-11/16	1.6	0.9	33	0.95
AG-105AC	Lever	125	5	10,900	5/8 x 11 UNC	76	3	208	8-3/16	2.1	0.9	33	0.95
AG-105BP	Lever	125	5	10,900	M14 x 2.0P	76	3	208	8-3/16	2.1	0.9	33	0.95
AG-105ACB	Roll	-	-	6,000	5/8 x 11 UNC	98	3-55/64	208	8-3/16	1.4	0.9	33	0.95
AG-105BCB	Lever	-	-	6,000	5/8 x 11 UNC	98	3-55/64	246	8-3/16	1.4	0.9	33	0.95
AG-107AC	Roll	180	7	7,600	5/8 x 11 UNC	87	3-27/64	253	10	4.05	2	56	1.6
AG-107AN	Roll	180	7	7,600	M10 x 1.5P	87	3-27/64	253	10	4.05	2	56	1.6
AG-107AP	Roll	180	7	7,600	M14 x 2.0P	87	3-27/64	253	10	4.05	2	56	1.6
AG-107BC	Lever	180	7	7,600	5/8 x 11 UNC	87	3-27/64	300	11-13/16	3.79	2	56	1.6
AG-107BN	Lever	180	7	7,600	M10 x 1.5P	87	3-27/64	300	11-13/16	3.79	2	56	1.6
AG-107BP	Lever	180	7	7,600	M14 x 2.0P	87	3-27/64	253	10	3.79	2	56	1.6
AG-109AC	Roll	230	9	5,900	5/8 x 11 UNC	115	4-1/2	280	11	4.32	2.5	67	1.9
AG-109AN	Roll	230	9	5,900	M10 x 1.5P	115	4-1/2	280	11	4.32	2.5	67	1.9
AG-109AP	Roll	230	9	5,900	M14 x 2.0P	115	4-1/2	280	11	4.32	2.5	67	1.9
AG-109BC	Lever	230	9	5,900	5/8 x 11 UNC	115	4-1/2	310	12-13/64	4.06	2.5	67	1.9
AG-109BN	Lever	230	9	5,900	M10 x 1.5P	115	4-1/2	310	12-13/64	4.06	2.5	67	1.9
AG-109BP	Lever	230	9	5,900	M14 x 2.0P	115	4-1/2	310	12-13/64	4.06	2.5	67	1.9

**Guide to Model Ref.**

AG-104 A F – Spindle Type (F=3/8 x 24UNF ; C=5/8 x 11UNC ; M=M8 x 1.25P ; N=M10 x 1.5P ; P=M14 x 2.0P)

Throttle Type ( A=Roll ; B=Lever)

Grinder Wheel (4=4 inch ; 5=5 inch ; 7=7 inch)

# VERTICAL GRINDERS



VG-5BH-1M



VG-7BH-2MC (5/8-11UNC)  
VG-7BH-2MP (M14 X 2.0P)  
VG-7BH-4MC (5/8-11UNC)  
VG-7BH-4MP (M14 X 2.0P)



VG-9BH-1M  
VG-9BH-2M



VG-9BH-3M  
VG-9BH-4M

Model	Grinding Wheel mm	Max. Dia Cup Wheel mm	Cutting Disc mm	Height		Free Speed R.P.M	Overall Length		Weight	Air Hose Size		HP	Max Air Consumption	
				mm	in		mm	in		mm	in		CFM	m <sup>3</sup> /min
VG-5BH-1M	125 x 6 x 22.2			174	6-27/32	12,000	232	9-9/64	2.8	12.7	½	1.4	42.4	1.2
VG-7BH-2M	180 x 6 x 22.2		180 x—x 22.2	192	7-9/16	7,000	247	9-23/32	4	12.7	½	2	56.5	1.6
VG-7BH-4M	180 x 6 x 22.2			192	7-9/16	8,400	247	9-23/32	4	12.7	½	2	56.5	1.6
VG-9BH-1M	230 x 10 x 22.2			204	8-1/32	6,000	279	10-63/64	5.8	19	¾	4	98.9	2.8
VG-9BH-2M	230 x 10 x 22.2		230 x—x 22.2	204	8-1/32	4,500	279	10-63/64	5.8	19	¾	3.8	87.7	2.4
VG-9BH-3M		150 x 50 x 22.2		222	8-47/64	6,000	279	10-63/64	5.9	19	¾	4	98.9	2.8
VG-9BH-4M		150 x 50 x 22.2		222	8-47/64	4,500	279	10-63/64	5.9	19	¾	3.8	87.7	2.4

# STRAIGHT GRINDERS



SG-105A  
SG-106A



SG-105B  
SG-106B



SG - 206B



SG - 306B

Model	Throttle Type	Grinding Wheel		Free Speed	Spindle Thread Size	Overall Length		Weight (kg)	HP	Air Hose Size	Air Inlet Thread Size	Max. Air Consumption SCFM
		mm	in			mm	in					
SG-105A	Roll	125 X 19 X 12.7	5 X 3/4 X ½	7,600	½ x 12	400	¾	2.97	1.3	12.7	3/8	20
SG-105B	Lever	125 X 19 X 12.7	5 X 3/4 X ½	7,600	½ x 12	501	11/16	2.97	1.3	12.7	3/8	20
SG-106A	Roll	150 X 25 X 15.8	6 X 1 X 5/8	6,900	5/8 x 11	425	16-47/64	4.14	1.4	12.7	3/8	24
SG-106B	Lever	150 X 25 X 15.8	6 X 1 X 5/8	6,300	5/8 x 11	521	20-33/64	4.14	1.4	12.7	3/8	24
SG-206B	Lever	150 X 25 X 22	6 X 3/32 X 7/8	6,300	5/8 x 11	510	20	4.14	1.4	12.7	3/8	24
SG-306B	Lever	5/8" Cone Wheel		6,300	5/8 x 11	510	20	3.27	1.4	12.7	3/8	24

# [L] TYPE OFFSET DRILL ATTACHMENT

13029



L82 x W22.3 x H49(9.15)

13529



L150 x W22.3 x H49(9.15)

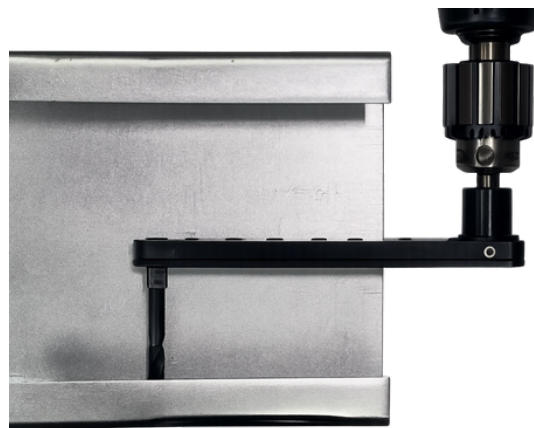



## 芳宇達有限公司



Tel: 886-3-3613535 886-3750279



Fax: 886-3-3750280



Email: [finedarer20@gmail.com](mailto:finedarer20@gmail.com)



Web: [finedarer.com](http://finedarer.com)